

Linear & Slot Diffuser Plenum Boxes

Description

For supply or extract air, plenum boxes to be rear mounted on linear type diffusers. An integral air equalisation baffle is fitted as standard below the air inlet spigot. Available with thermal and acoustic insulation and square or round volume control dampers.

Construction

From 20 gauge galvanised sheet steel to HVCA Specification DW144. All joints fully sealed and welds suitably treated.

Size

From 100 x 100 to 1800 x 600 in 25mm increments.

How to Specify

STATE QUANTITY, THE PRODUCT CODING AND THE SIZE WIDTH X HEIGHT
 e.g. 10 Qty. G700R+00 1200 x 300 - 200 Diameter.

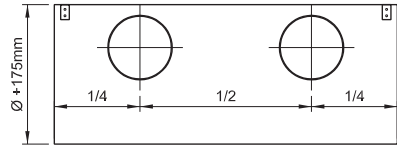

G7020

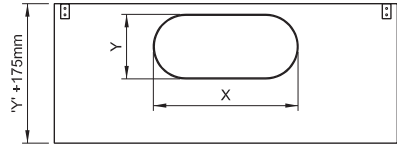

G7030

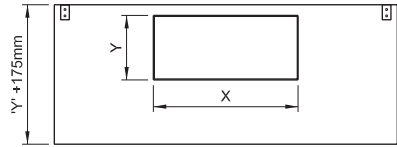

G7040

Plenum Type	Insulation	Spigot	Accessories
G7 Standard Plenum Box	0 None	0 1 Spigot	0 None
G8 Single Offset Side	B 13mm Pyrosorb Internal Lining	2 2 Spigots	R Type 'R' Damper
G9 Double Offset Sides		3 Flat Oval	F Type 'F' Damper
		4 Square / Rectangular	W Cord Operated Damper

Fixings	Finish
0 None	0 Galvanised / Zintec Coated Mild Steel
8 Hemmed Edges	C PPC BS / RAL Colour
F 17mm External Flange	

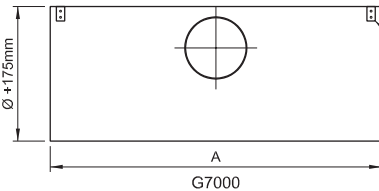

4 No. drop rod lugs fitted as standard

Fixing code 't8' Hemmed Edges

