

Perforated Face Grille

Description

For return air, having a perforated panel core which provides an attractive yet practical finish. Suitable for wall, duct and ceiling mounting.

Construction

The frame is from 1.6mm thick extruded aluminium section with a perforated sheet core. Hairline mitres mechanically held. Optional OBD is of extruded aluminium.

Size and Weight

From 100 x 100 to 1200 x 1200 in 25mm increments. Face mullions are incorporated when width exceeds 1050mm. Grille only 8.5kg/m², Grille + OBD 16.5kg/m²
Free Area approximately 48%

How to Specify

STATE QUANTITY, THE PRODUCT CODING AND THE SIZE WIDTH X HEIGHT
e.g. 10 Qty. S600V+1C 300 x 150



Frame Style	Core	Options	Accessories
S 30mm Flange	60 Perforated Core Round Hole	0 Fixed Core	0 None
C Channel Frame	61 Perforated Core Square Hole	H Hinged Core	V Damper
0 Core Only		R Removable Core	

+

Fixings	Finish
1 Flange Holes	C PPC BS /RAL Colour
2 Neck Fixings	D Mill Finish
6 Lay-In Tile Replacer	

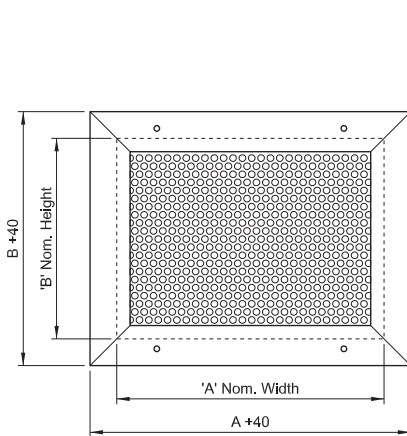

S600V
(With Damper)

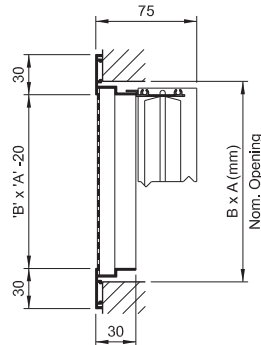

S6000
(Without Damper)

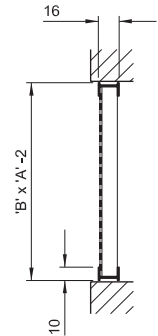

C6000

Technical Data Sidewall Mounted Extract Air Grilles

S840V 45° Fixed Blade

S890V 45° Fixed Blade

S600V Perforated

A6000 Perforated

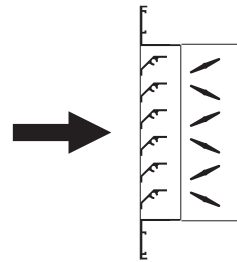

Ac (M ²)	APERTURE A x B (mm)	Vf (M/S)	1.5	2.0	2.5	3.0	3.5	4.0	5.0
		Psn (Pa)	7	11	19	27	35	45	70
0.017	200 x 100	I/s	25	35	40	50	60	70	85
	150 x 150	NC	-	-	22	25	29	35	40
0.024	200 x 150	I/s	40	50	60	75	85	100	120
	350 x 100	NC	-	15	22	26	30	37	43
0.033	250 x 150	I/s	50	65	85	100	115	13	165
	200 x 200	NC	-	15	23	27	32	39	44
0.042	350 x 150	I/s	65	85	105	125	150	170	215
	250 x 200	NC	-	16	24	29	33	41	46
0.051	400 x 150	I/s	80	105	130	155	180	210	260
	300 x 200	NC	-	17	25	30	35	42	47
0.065	500 x 150	I/s	100	130	165	200	230	265	330
	350 x 200	NC	-	18	27	31	37	43	49
0.079	350 x 250	I/s	120	160	200	240	280	320	400
	300 x 300	NC	-	20	28	33	37	44	51
0.093	400 x 250	I/s	140	190	235	285	330	380	470
	350 x 300	NC	-	21	30	33	38	45	53
0.111	500 x 250	I/s	170	225	285	340	400	455	565
	350 x 350	NC	-	22	30	34	40	46	55
0.125	400 x 350	I/s	190	255	320	380	445	510	635
	450 x 300	NC	-	23	31	34	41	46	-
0.145	450 x 350	I/s	220	295	370	440	515	590	735
	400 x 400	NC	14	24	32	35	42	47	-
0.164	500 x 350	I/s	250	335	420	500	585	670	835
	450 x 400	NC	14	24	32	35	43	48	-
0.186	500 x 400	I/s	285	380	470	565	660	755	945
	450 x 450	NC	15	25	33	37	43	49	-
0.231	550 x 450	I/s	355	470	590	710	825	945	1180
	500 x 500	NC	16	27	34	38	44	52	-
0.251	600 x 450	I/s	380	510	635	765	890	1020	1275
	700 x 400	NC	16	27	34	38	44	53	-
0.300	750 x 450	I/s	455	605	755	905	1055	1210	1510
	800 x 400	NC	17	28	35	39	45	55	-
0.335	800 x 450	I/s	510	680	850	1020	1190	1365	1700
	600 x 600	NC	18	29	35	39	45	-	-
0.390	900 x 450	I/s	595	795	995	1190	1390	1590	1980
	1200 x 350	NC	19	29	36	41	47	-	-
0.510	900 x 600	I/s	775	1035	1295	1555	1810	2070	2585
	750 x 750	NC	20	30	37	43	49	-	-
0.570	1200 x 500	I/s	870	1160	1450	1740	2030	2320	2880
	1000 x 600	NC	21	32	37	44	50	-	-
0.686	1200 x 600	I/s	1045	1390	1750	2095	2445	2785	3500
	900 x 800	NC	23	34	39	46	55	-	-